

1 Connecting Your Plasma TV

Get the Picture

Your TV allows you to receive channels two ways. Connect a signal to either or both inputs as described below and then run a channel search to get the picture.

- The ANTENNA/CABLE ANALOG INPUT receives regular (analog) channels.
- A.** Connect a coaxial cable from the cable outlet to the ANTENNA/CABLE ANALOG INPUT to receive your cable channels. To receive off-air analog channels, connect a coaxial cable from an off-air antenna. Go to step B or step 2 *Setting Up Your Plasma TV*.
- The ANTENNA/CABLE DIGITAL INPUT receives digital channels.
- B.** Connect a coaxial cable from an off-air antenna to the ANTENNA/CABLE DIGITAL INPUT to receive your off-air digital channels. Go to step 2 *Setting Up Your Plasma TV*.

Get Free Digital TV Tip:

By connecting a signal to your ANTENNA/CABLE DIGITAL INPUT, you are capable of receiving free off-air digital channels if available in your area. If you're using an antenna and you need help deciding what type of antenna to use, go to antennaweb.org. By entering where you live, this mapping program tells you what local analog and digital stations are available to you.

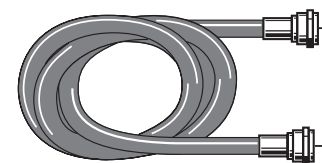
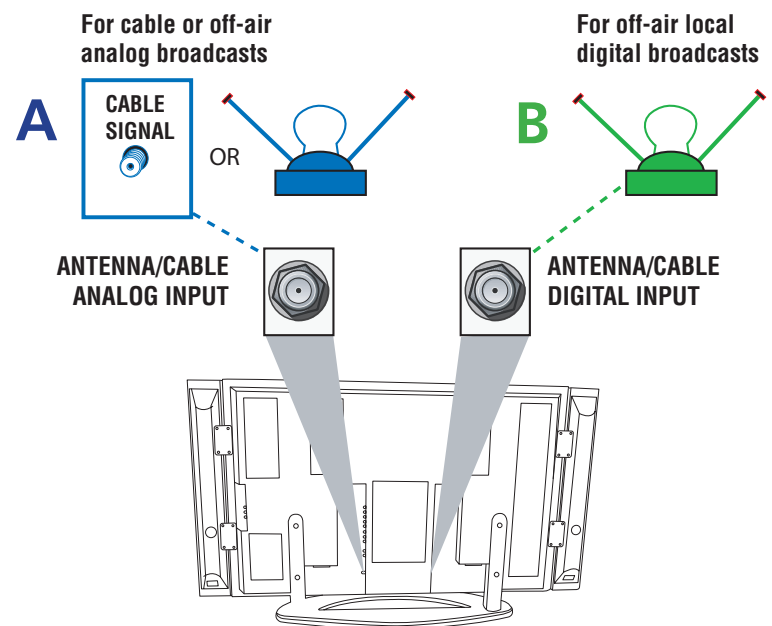

Use the coaxial cable from a cable outlet, off-air antenna, or cable box to connect to the ANTENNA/CABLE DIGITAL and ANALOG INPUTS.

Thank you for your purchase. Before making a trip back to the retailer, please refer to the enclosed User's Guide or contact us at the support number provided in your warranty so that we may assist you in operating the unit, replacing missing parts, and ensuring your satisfaction with the product.

2 Setting Up Your Plasma TV

Follow these steps to set up your TV. For more detailed instructions, refer to Chapter 1 of the User's Guide.

- Plug in the TV.**
- Put Batteries in the Remote.**
- Turn on the TV.**
- Complete the Initial Setup.** The first time you turn on your TV, the language screen automatically appears. Follow these steps:

Set the Menu Language. Press OK to select *English* and continue to the next step. Press the down arrow button to choose another language for the menu system and then press OK.

Complete Channel Setup.

1. Choose the Signal Source.

A. Did you connect a signal to both ANTENNA/CABLE ANALOG and DIGITAL INPUTS on the back of your TV? If not, go to step 1B. If so, press the down arrow button to highlight *Ana. signal type* and go to step 2.

B. Did you connect a signal to only the ANTENNA/CABLE ANALOG INPUT? If not, go to step 1C. If so, press the right arrow button to select *Analog* and then press the down arrow button to highlight *Ana. signal type*. Go to step 2.

C. Did you connect a signal to only the ANTENNA/CABLE DIGITAL INPUT? If not, go to step 2. If so, press the right arrow button to select *Digital* and then press the down arrow button to highlight *Dig. signal type*. Go to step 3.

2. Set Analog Signal Type.

A. Did you connect cable to the ANTENNA/CABLE ANALOG INPUT? If not, go to step 2B. If so, leave the option set to *Cable* and then press the down arrow button to highlight *Dig. signal type*. Go to step 3.

B. Did you connect an antenna to the ANTENNA/CABLE ANALOG INPUT? If not, go to step 3. If so, press the right arrow button to highlight *Antenna* and then press the down arrow button to highlight *Dig. signal type*. Go to step 3.

3. Set Digital Signal Type. If you connected a signal to the ANTENNA/CABLE DIGITAL INPUT, leave the option set to *Autodetection*. The signal type is chosen for you and changes on-screen according to that type once a signal is detected. Press the down arrow button to highlight *Auto Ch. search*.

4. Complete Channel Search. Even though the initial channel search can take several minutes, you must complete it in order for your TV to display channels and programming. Press OK to begin the channel search. The menu shows the TV is running a channel search. When it's complete, the *Channel setup* menu remains on-screen. To exit the menu system, press CLEAR or press OK to edit the channel list. For detailed instructions on removing channels from your channel list, refer to the *Setup Menu* in Chapter 3 of the User's Guide.

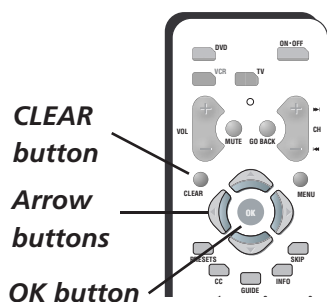

Use these buttons during the Initial Setup

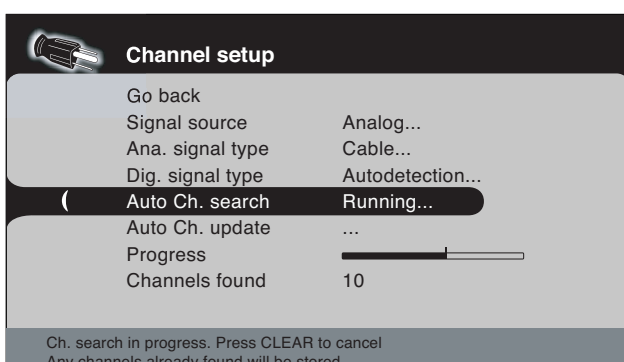
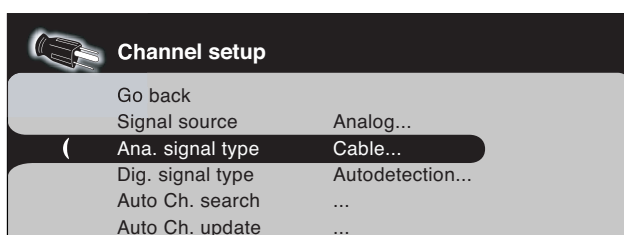
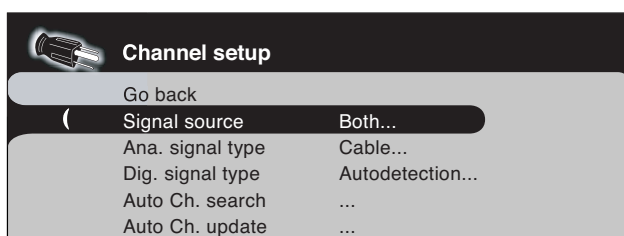

3 Connecting To Jacks on Your Plasma TV

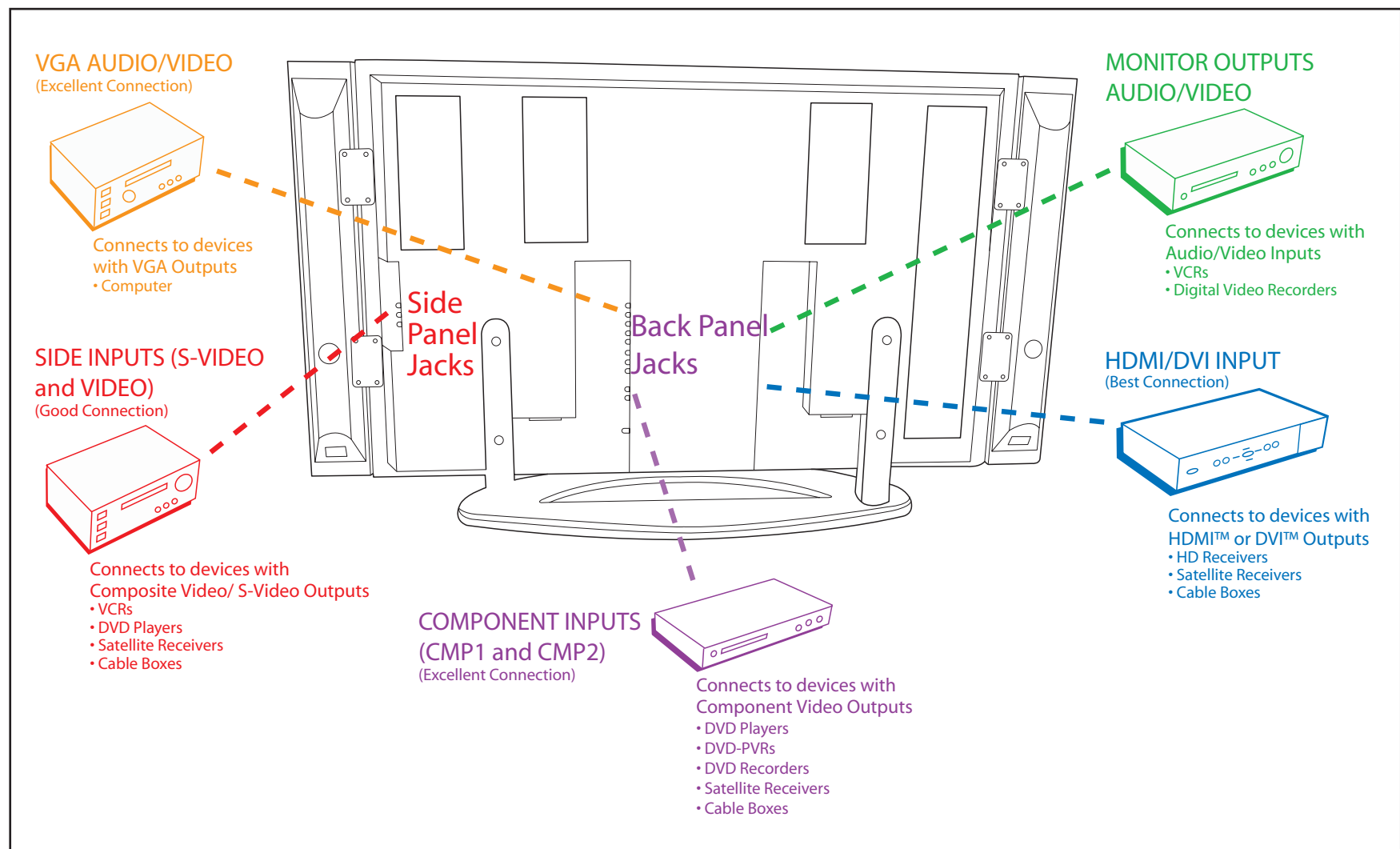

There are several ways to connect your TV, depending on the types of output jacks the devices you want to connect have. For more information about connecting your TV to other devices, refer to Chapter 1 of the User's Guide.

HDMI, the HDMI logo, and High-Definition Multimedia Interface are trademarks or registered trademarks of HDMI Licensing LLC.,

4 Operating Your Plasma TV

Watching TV

Now that you've completed the setup, you're ready to watch TV. Here are some things to be aware of:

- Did you connect both digital and regular (analog) signals to the back of your TV? If so, press the ANTENNA button to switch between the two signals. Look for an *A* at the bottom of the screen for the Analog Input; look for a *D* at the bottom for the Digital Input. See the examples on the left.
- To tune to a digital channel with a sub-channel, enter the primary channel number, then press the right arrow button. Enter the sub-channel number and press OK.
- Analog video is sent in a 4/3 format, which your TV displays in a 16/9 format. Press the left or right arrow button to view the different formats available.
- Most digital video is sent in a 16/9 format which does fill your screen, but sometimes is sent in 4/3 which does not fill your screen. It depends on how the station or source device is formatting the video. If there are bars on-screen, press the left or right arrow button to try a different format that may eliminate the bars.



Look for the *A* at the bottom of the screen to make sure you're on the Analog Input.

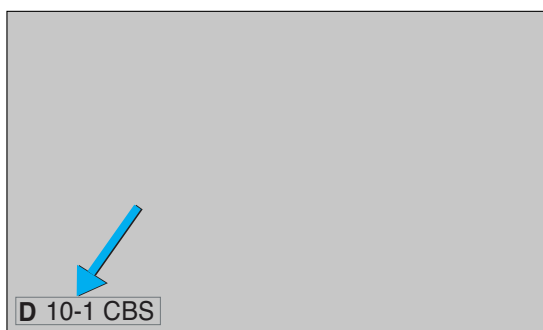

Look for the *D* at the bottom of the screen to make sure you're on the Digital Input.

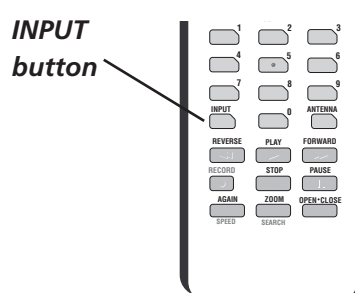

Use the **INPUT** button to view devices you've connected to your TV

Viewing Devices Connected to Your TV

What jacks on the back or on the side of the TV did you connect the device? You might need to look at the label next to the jacks. These are your choices: VIDEO, S-VIDEO, CMP1, CMP2, VGA or HDMI/DVI.

If you've connected a device, such as a DVD player, to your TV and you want to view the device:

1. Turn on the TV and the DVD player.
2. Repeatedly press the INPUT button on the remote control to scroll through the Video Input Channels until you see the input corresponding with the jack you have the device connected. For example, if you have the DVD player connected to the CMP1 Input, look for *CMP1* to appear at the bottom of the TV's screen.